



● JC071-1

NOTE:  
PRODUCT TO BE MET ROHS

**1. MATERIAL**  
HOUSING: Pa46 +30%GF,UL94V-0,COLOR: BALCK  
PLUNGER:BRASS,3u" GOLD PLATING 50u" MIN,NICKEL  
UNDERPLATE  
BARREL:BRASS3u"GOLD PLATING OVER 50u"MIN,NICKEL  
UNDERPLATED  
SPRING: SUS304

**2.SPECIFICATION**

**ELECTRICAL**  
CURRENT RATING:12VDC,1A  
INSULATION RESISTANCE:100m Min  
CONTACT RESISTANCE :50M Max  
ENVIRONMENTAL:  
TEMPERATURE RANGE:-40°C ~85°C

**3.MECHANICAL FUNCTION:**

SPRING PROBE FORCE:  
WORKING STROKE (SINGLE PIN):140gf±20gf AT 1.00mm RECOMMEND STROE  
MAX.STROKE:1.50mm FULL STROKE  
DURABILITY:10,000 CYCLES 1.20mm STROKE

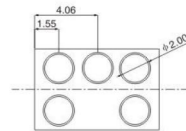
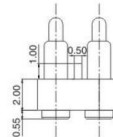
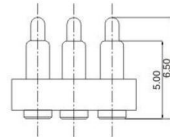
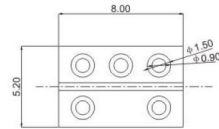

● JC429

**1.MATERIAL**

1-1 CONTACT PIN: COPPER ALLOY  
1-2 SOLDER PAD: COPPER ALLOY  
1-3 SPRING: SWP-B.PIANO WIRE OR EQUIVALENT  
1-4 HOUSING: HIGH-TEMPRESIN RATED,  
UL-94V-0,BLACK

**2.MECHERCAL SPECIFICATION:**

2-1 CONTACTFORCE(PER CONTACT):  
95±20gf AT 0.80mm WORKING HEIGHT  
2-2 MAXMUM FULL STROKE: 1.70mm  
WORKING HEIGHT: 0.80mm  
2-3 DURABILITY: 10,000 CYCLES

**3.ELECTRICAL SPECIFICATION:**

3-1 RATED VOLTAGE(PER CONTACT): 12 VOLTS MAX.  
3-2 RATED CURRENT(PER CONTACT): 2 AMPS MAX.  
3-3 CONTACT RESISTANCE: 30 MILLIOHMS MAX.

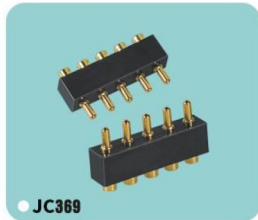
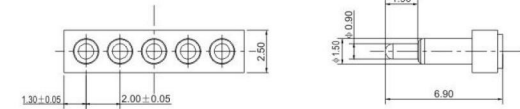
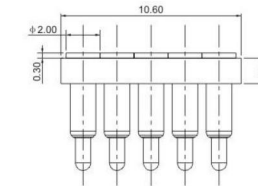

● JC369

**1.MATERIAL**

1-1 CONTACT PIN: COPPER ALLOY  
1-2 SOLDER PAD: COPPER ALLOY  
1-3 SPRING: SWP-B.PIANO WIRE OR EQUIVALENT  
1-4 HOUSING: HIGH-TEMPRESIN RATED,  
UL-94V-0,BLACK

**2.MECHERCAL SPECIFICATION:**

2-1 CONTACTFORCE(PER CONTACT):  
95±20gf AT 0.80mm WORKING HEIGHT  
2-2 MAXMUM FULL STROKE: 1.70mm  
WORKING HEIGHT: 0.80mm  
2-3 DURABILITY: 10,000 CYCLES

**3.ELECTRICAL SPECIFICATION:**

3-1 RATED VOLTAGE(PER CONTACT): 12 VOLTS MAX.  
3-2 RATED CURRENT(PER CONTACT): 2 AMPS MAX.  
3-3 CONTACT RESISTANCE: 30 MILLIOHMS MAX.

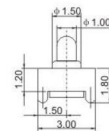
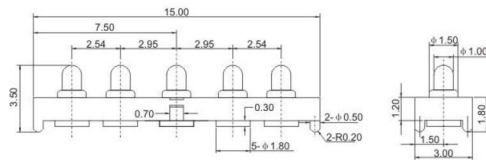

● JC369

NOTE:  
PRODUCT TO BE MET ROHS

**1. MATERIAL**

HOUSING:PA46 +30%GF,UL94V-0 COLOR:BLACK  
PLUNGER:BRASS,(SEE TABLE)"GOLD PLATING OVER 50u"MIN,NICKEL  
UNDERPALATEE  
BARREL:BRASS,(SEE TABLE)"GOLD PLATING OVER 50u"MIN,NICKEL  
UNDERPLATED  
SPRING:SUS304

**2.SPECIFICATION:**

**ELECTRICAL**  
CURRENT RATING:12VDC,1A  
INSULATION RESISTANCE:100m Min  
CONTACT RESISTANCE:50m Max  
ENVIRONMENTAL  
TEMPERATURE RANGE:-40°C ~85°C

**3.MECHANICAL FUNCTION:**

SPRLNG PROBE FORCE  
WORKING STROKE(PIN):SEE TABLE AT 1.50mm RECOMMEND STROE  
MAX.STROKE:2.0mm FULL STROKE  
DURABILITY:10,000 CYCLES/1.50mm STROKE

