

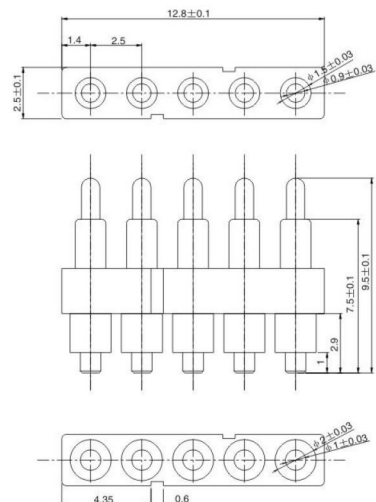

● **JC829**

- 1.MATERIAL**
1-1 CONTACT PIN: COPPER ALLOY
1-2 SOLDER PAD: COPPER ALLOY
1-3 SPRING: SWP-B,PIANO WIRE OR EQUIVALENT
1-4 HOUSING: HIGH-TEMPRESIN RATED, UL-94V-0, BLACK
- 2.MECHERCAL SPECIFICATION:**
2-1 CONTACTFORCE(PER CONTACT): 60±20gf AT 1.0mm WORKING HEIGHT
2-2 MAXMUM FULL STROKE: 1.8mm WORKING HEIGHT: 1.0mm
2-3 DURABILITY: 10,000 CYCLES
- 3.ELECTRICAL SPECIFICATION:**
3-1 RATED VOLTAGE(PER CONTACT): 12 VOLTS MAX.
3-2 RATED CURRENT(PER CONTACT): 2 AMPS MAX.
3-3 CONTACT RESISTANCE: 30 MILLIOHMS MAX.



● **JC264**

- NOTE:**
PRODUCT TO BE ME TYCO SPEC 230-702
- 1.MATERIAL**
HOUSING: PA46+30%GF,UL94V-0,COLOR: BLACK
PLUNGER: BRASS,3u" GOLD PLATING
50u" MIN.NICKEL UNDERPLATEE.
BARREL:BRASS,3u" GOLD PLATING OVER
50u" MIN.NICKEL UNDER PLATED
SPRING:SUS304
- 2.SPECIFICATION**
ELECTRICAL
CURRENTRATNG: 12VDC,1A
INSULATION RESISTANCE:100m Min
CONTACT RESISTANCE:50m Max.
TEMPERATURE RANGE: -40°C ~85°C

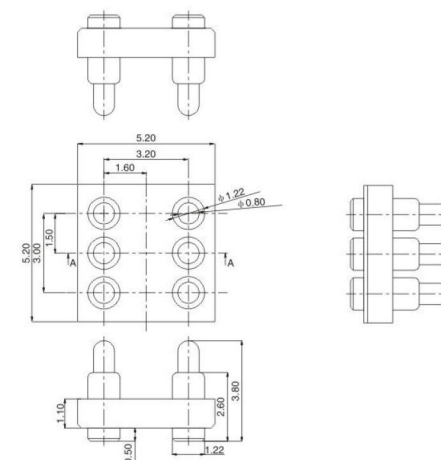

● **JC860**

- 1.MATERIAL**
1-1 CONTACT PIN: COPPER ALLOY
1-2 SOLDER PAD: COPPER ALLOY
1-3 SPRING: SWP-B,PIANO WIRE OR EQUIVALENT
1-4 HOUSING: HIGH-TEMPRESIN RATED, UL-94V-0, BLACK
- 2.MECHERCAL SPECIFICATION:**
2-1 CONTACTFORCE(PER CONTACT): 60±20gf AT 1.5mm WORKING HEIGHT
2-2 MAXMUM FULL STROKE: 1.7mm WORKING HEIGHT: 1.5mm
2-3 DURABILITY: 10,000 CYCLES
- 3.ELECTRICAL SPECIFICATION:**
3-1 RATED VOLTAGE(PER CONTACT): 12 VOLTS MAX.
3-2 RATED CURRENT(PER CONTACT): 2 AMPS MAX.
3-3 CONTACT RESISTANCE: 30 MILLIOHMS MAX.

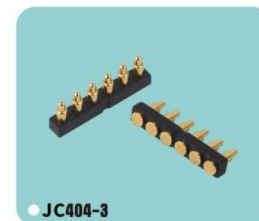
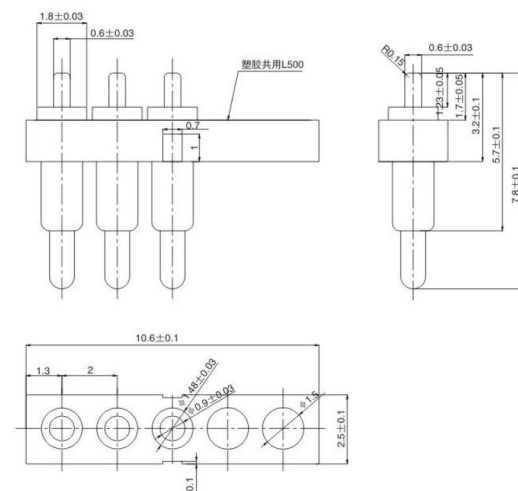

● **JC404-3**

- 1.MATERIAL**
1-1 CONTACT PIN: COPPER ALLOY
1-2 SOLDER PAD: COPPER ALLOY
1-3 SPRING: SWP-B,PIANO WIRE OR EQUIVALENT
1-4 HOUSING: HIGH-TEMPRESIN RATED, UL-94V-0, BLACK
- 2.MECHERCAL SPECIFICATION:**
2-1 CONTACTFORCE(PER CONTACT): 120±20gf AT 1.0mm WORKING HEIGHT
2-2 MAXMUM FULL STROKE: 1.3mm WORKING HEIGHT: 1.0mm
2-3 DURABILITY: 10,000 CYCLES
- 3.ELECTRICAL SPECIFICATION:**
3-1 RATED VOLTAGE(PER CONTACT): 12 VOLTS MAX.
3-2 RATED CURRENT(PER CONTACT): 2 AMPS MAX.
3-3 CONTACT RESISTANCE: 30 MILLIOHMS MAX.

