

NOTES:  
1. MATERIAL: SEE "TABLE 1";  
2. FINISH: SEE "TABLE 1";

3. ELECTRICAL:  
3-1. CONTACT CURRENT RATING:  
5A (BUS PIN 1.5A/PIN),  
5A (GND PIN 1.25A/PIN MAX), 0.25A/PIN (OTHER PIN).  
3-2. INSULATION RESISTANCE:  
100 MEGAΩMS MIN. AT 250VDC.  
3-3. DIELECTRIC WITHSTANDING VOLTAGE:  
100VAC MIN.  
3-4. LOW LEVEL CONTACT RESISTANCE:  
INITIAL 40mΩ MAX.  
AFTER 50mΩ MAX.

4. MECHANICAL CHARACTERISTICS:  
4-1. MATING FORCE: 5-20N;  
4-2. UNMATING FORCE: 8-20N (INITIAL), 6-20N (AFTER 10000 CYCLES);  
4-3. DURABILITY: 10,000 MATING CYCLES.  
4-4. OPERATING TEMPERATURE: -40°C TO +80°C

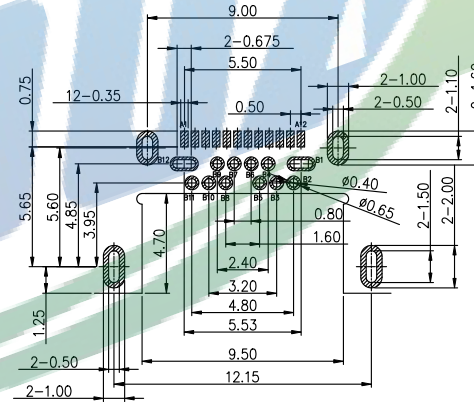
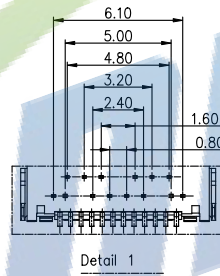
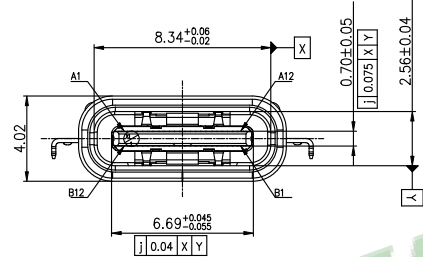

RECOMMENDED P.C.B LAYOUT (Both sides are sample)  
Tolerance: ±0.05, Thickness=0.60mm

| Pin   | Signal Name | Mating Sequence | Pin   | Signal Name | Mating Sequence |
|-------|-------------|-----------------|-------|-------------|-----------------|
| A1    | GND         | First           | B12   | GND         | First           |
| A2    | SSTXp1      | Second          | B11   | SSRXp1      | Second          |
| A3    | SSTXn1      | Second          | B10   | SSRXn1      | Second          |
| A4    | Vaus        | First           | B9    | Vaus        | First           |
| A5    | CC1         | Second          | B8    | SBU2        | Second          |
| A6    | Dp1         | Second          | B7    | Dn2         | Second          |
| A7    | Dn1         | Second          | B6    | Dp2         | Second          |
| A8    | SBU1        | Second          | B5    | CC2         | Second          |
| A9    | Vaus        | First           | B4    | Vaus        | First           |
| A10   | SSRXn2      | Second          | B3    | SSTXn2      | Second          |
| A11   | SSRXp2      | Second          | B2    | SSTXp2      | Second          |
| A12   | GND         | First           | B1    | GND         | First           |
| SHELL | GND         |                 | SHELL | GND         |                 |

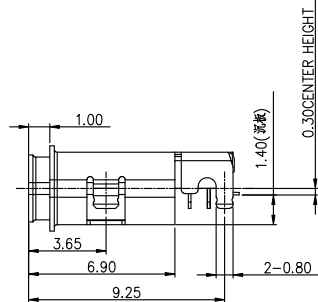
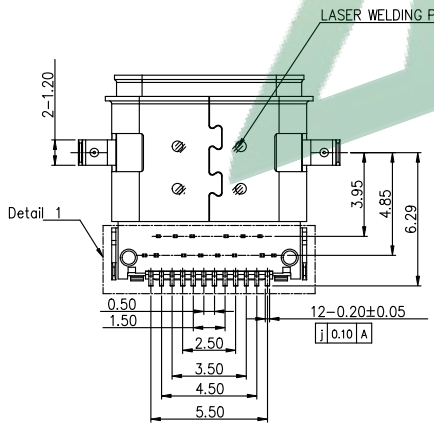

**振端精密科技 (深圳) 有限公司**  
Zhenduan precision technology (Shenzhen) Co., Ltd

|   |                            |                      |  |
|---|----------------------------|----------------------|--|
| TOLERANCE:<br>X.XX ±0.30<br>X.X ±0.20<br>X.XXX ±0.10<br>X.X ±0.10<br>X.X ±0.05<br>X.X ±0.02 | DRAWN BY :<br><b>刘志强</b>   | DATE :<br>2015.08.18 | PART NAME:<br><b>TYPE-C 24P防水沉板卷口L9.65</b> |
| UNIT: mm [inch]<br>SCALE: 1:1 SIZE: A4  | CHECKED BY:<br><b>李毅</b>   | DATE :<br>2015.08.18 | PART NO. :<br><b>SEE TABLE</b>             |
|   | APPROVED BY:<br><b>张少辉</b> | DATE :<br>2015.08.18 | MOLD NO. :<br><b>ZDHS2400FS092</b>         |
|   |                            |                      | DRAW NO. :<br><b>1 OF 1</b>                |

建议密封方式

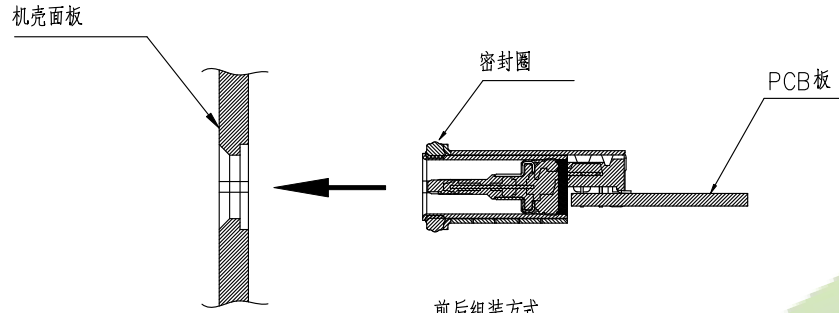

前后组装方式

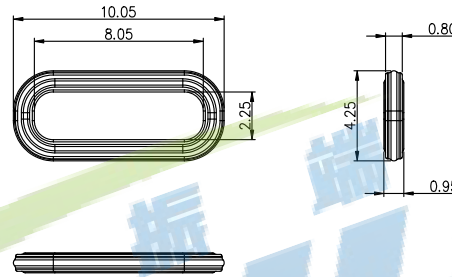

建议防水圈规格 (材质硅橡胶)

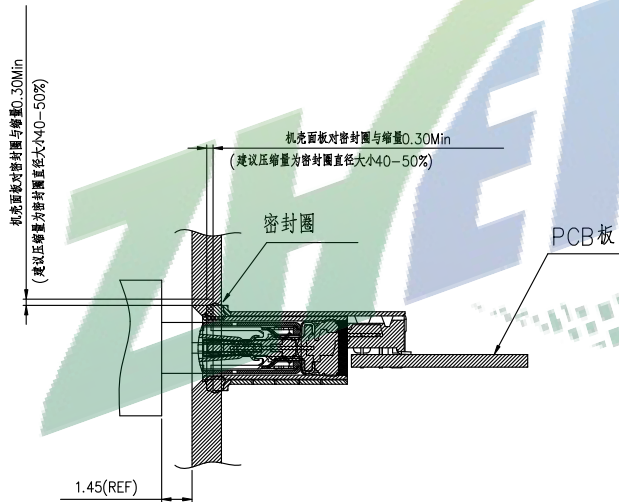

组装面板后公母头对插示意图

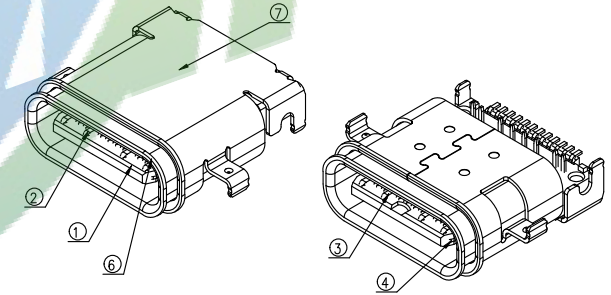

TABLE 1:

| NO. | PART NAME  | QTY | MATERIAL        | DESCRIPTION    | REMARK   |
|-----|------------|-----|-----------------|----------------|----------|
| ⑧   | GLUE WATER | 1   | EPOXY           | BLACK;         |          |
| ⑦   | Shell-2    | 1   | Stainless steel | N PLATING;     | T=0.20mm |
| ⑥   | Shell-1    | 1   | Stainless steel | N PLATING;     | T=0.20mm |
| ⑤   | GND PLATE  | 1   | Stainless steel | N PLATING;     | T=0.10mm |
| ④   | MID PLATE  | 1   | Stainless steel |                | T=0.15mm |
| ③   | Terminal-B | 12  | 铜镍硅合金           | Au/Ni PLATING; | T=0.12mm |
| ②   | Terminal-A | 12  | 铜镍硅合金           | Au/Ni PLATING; | T=0.12mm |
| ①   | Housing    | 1   | HIGH TEMP       | Black          |          |



振端精密科技 (深圳) 有限公司  
Zhenduan precision technology (Shenzhen) Co., Ltd

|   |               |            |            |           |
|---|---------------|------------|------------|-----------|
| TOLERANCE:<br>X.X ± 0.30<br>X.XX ± 0.20<br>X.XXX ± 0.10<br>X.X ± 0.10<br>X.X ± 0.05<br>X.X ± 0.05 | DRAWN BY :    | DATE :     | PART NAME: |           |
|   | 刘志强           | 2015.08.18 |            |           |
| <br>UNIT: mm [inch]<br>SCALE: 1:1 SIZE: A4  | CHECKED BY :  | DATE :     | PART NO.   | SEE TABLE |
|   | 李文毅           | 2015.08.18 | MOLD NO.   |           |
|   | APPROVED BY : | DATE :     | DRAW NO.   |           |
|   | 张少辉           | 2015.08.18 | SHEET NO.  | 1 OF 1    |