

组装示意图

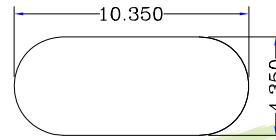

建议开口尺寸
组装时擦环保润滑油

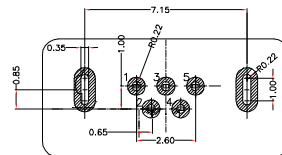
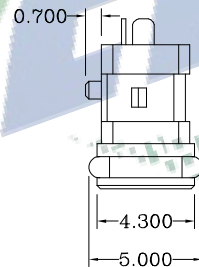
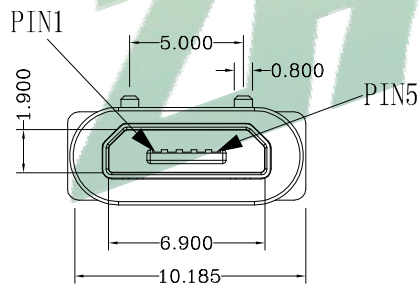
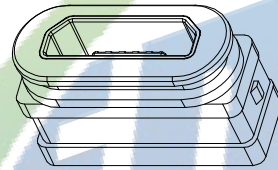
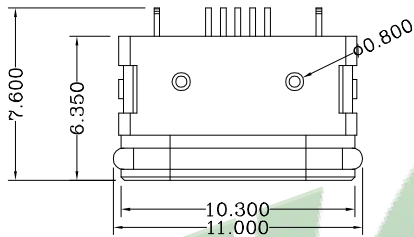

RECOMMENDED P.C.B LAYOUT

PIN1	VBUS
PIN2	D-
PIN3	D+
PIN4	ID
PIN5	GND

规格说明: Specifications:

电气特性: Electrical:

1. 额定电流: Current Rating
1.5A/contact terminal
2. 额定电压: Voltage Rating
30V DC
3. 接触阻抗: Contact Resistance
30 milliohms MAX
4. 耐电压: Dielectric Withstanding Voltage:
500 V AC AT Sea Level
5. 绝缘阻抗: Insulation Resistance:
1000MEGA ohms MIN

物理性能: Mechanical:

1. 插拔力: Connector Mate and Unmate Force
Mate force: 3.57kgf (MAX)
Unmate force: 1.02kgf (MIN)

原材料: Material:

1. 塑胶: Housing:
LCP
2. 端子: Contact: Copper Alloy C5191
3. 外壳: Shell: Copper Alloy SUS

电镀: Finish:

1. 端子: Contact: Plated Gold in Mating Area;
Tin On Solder Tails

2. 外壳: Shell:

铜壳四周镀80U”(MIN)锡

Nickel Plating

振端精密科技 (深圳) 有限公司 Zhenduan precision technology (Shenzhen) Co., Ltd			
TOLERANCE: X X ±0.30 X XX ±0.20 X XXX ±0.10 X ° ±10° X ° ±5°	DRAWN BY : 陈少龙	DATE : 2015.08.18	PART NAME: MC5P防水母座立式插板L6.35MM
UNIT: mm [inch] SCALE: 1:1 SIZE: A4	CHECKED BY: 陈少龙	DATE : 2015.08.18	PART NO. SEE TABLE MOLD NO.
	APPROVED BY: 陈少龙	DATE : 2015.08.18	DRAW NO.: ZDJNKJ000MC210 SHEET NO. 1 OF 1